

1250 Universal pump

1251 Pump for pond filter 3451

1253 Pump for external filter 2250

3250 Fountain set

EHEIM

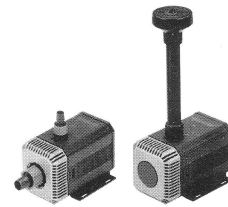

Spare parts. Subject to change without prior notice.

1250/1251/1253/3250

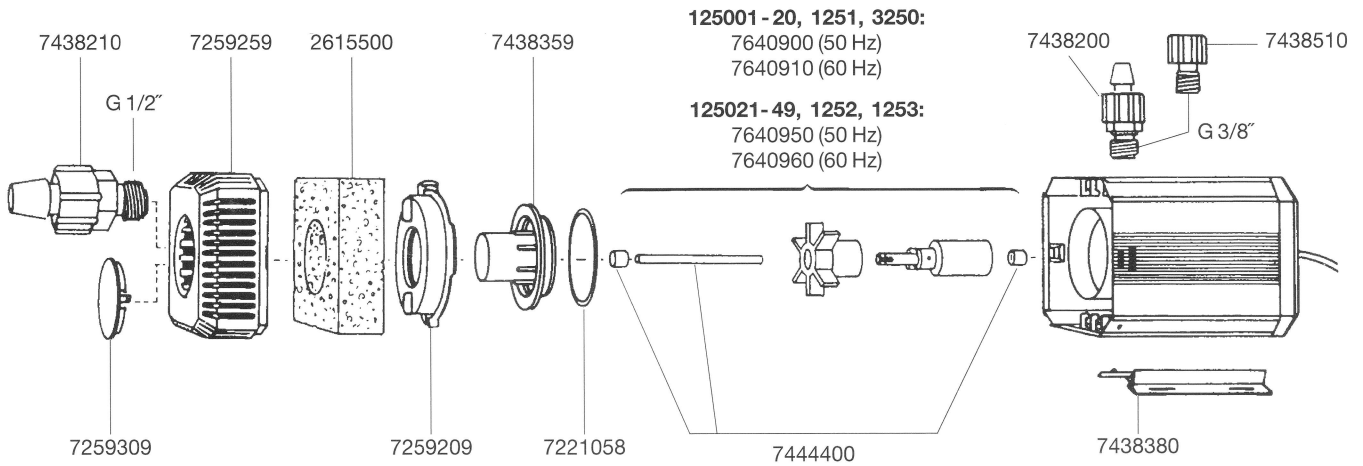

| Order no. | Spare part | 1250 / 1251 / 1253 / 3250 |
|-----------|-------------------------------------|---------------------------|
| 2615500 | Coarse foam (2 pieces) | |
| 3052200 | „Volcano“ double jet (not shown) | |
| 4009560 | Set of cleaning brushes (not shown) | |
| 7221058 | Sealing ring (2 pieces) | |
| 7259209 | Holding ring | |
| 7259259 | Intake screen | |
| 7259309 | Sealing cover | |
| 7438200 | Threaded connector pressure side | |
| 7438210 | Threaded connector suction side | |

| Order no. | Spare part | 1250 / 1251 / 1253 / 3250 |
|-----------|---|---------------------------|
| 7438359 | Pump cover | |
| 7438380 | Attachment sleeves left and right and 2 panels | |
| 7438510 | Adapter and sealing ring | |
| 7438559 | Pump cover for pump 1251/1252 | |
| 7438390 | Set of sealing rings (one each) for hose 17 x 2.5 and 14 x 2 (not shown) | |
| 7444400 | Set shaft with bushings | |
| 7640900 | Impeller (50 Hz) complete with shaft and bushings for 125001 - 20, 1251, 3250 | |
| 7640910 | Impeller (60 Hz) complete with shaft and bushings for 125001 - 20, 1251, 3250 | |
| 7640950 | Impeller (50 Hz) complete with shaft and bushings for 125021 - 49, 1252, 1253 | |
| 7640960 | Impeller (60 Hz) complete with shaft and bushings for 125021 - 49, 1252, 1253 | |